



Drawing:
28 mm Ring

Stock Code:
28RG0050000RING

Manufacturing Process:
Injection Molding

Stock Color:
Natural

Gram Weight:
0.75 ± 0.05

Case Pack:
10,300

Case Weight (lb):
19 ± 1.3

Cases Per Pallet:
30

Box Dimensions:
24 x 12 x 12 1/2

Stock Material:



CLASSIC CONTAINERS INC

1700 S. Hellman Ave.
Ontario, CA 91761

Phone: 909-930-3610

e-mail: info@classiccontainers.com

www.classiccontainers.com

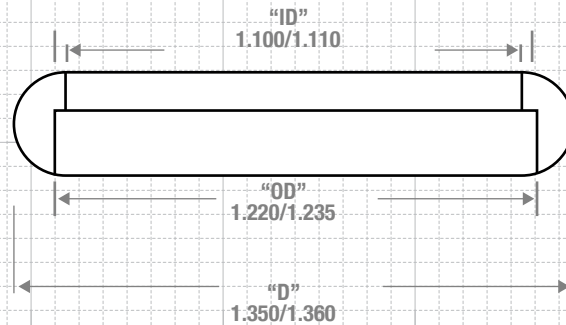
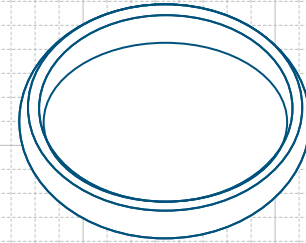

CLOSURE 28 mm

