

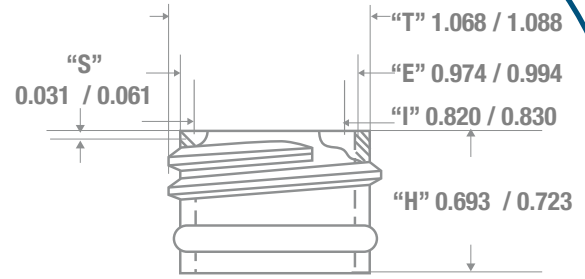

NECK & THREAD DETAIL

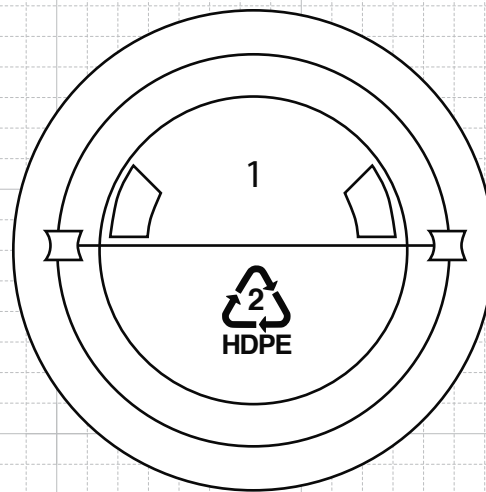

FRONT VIEW

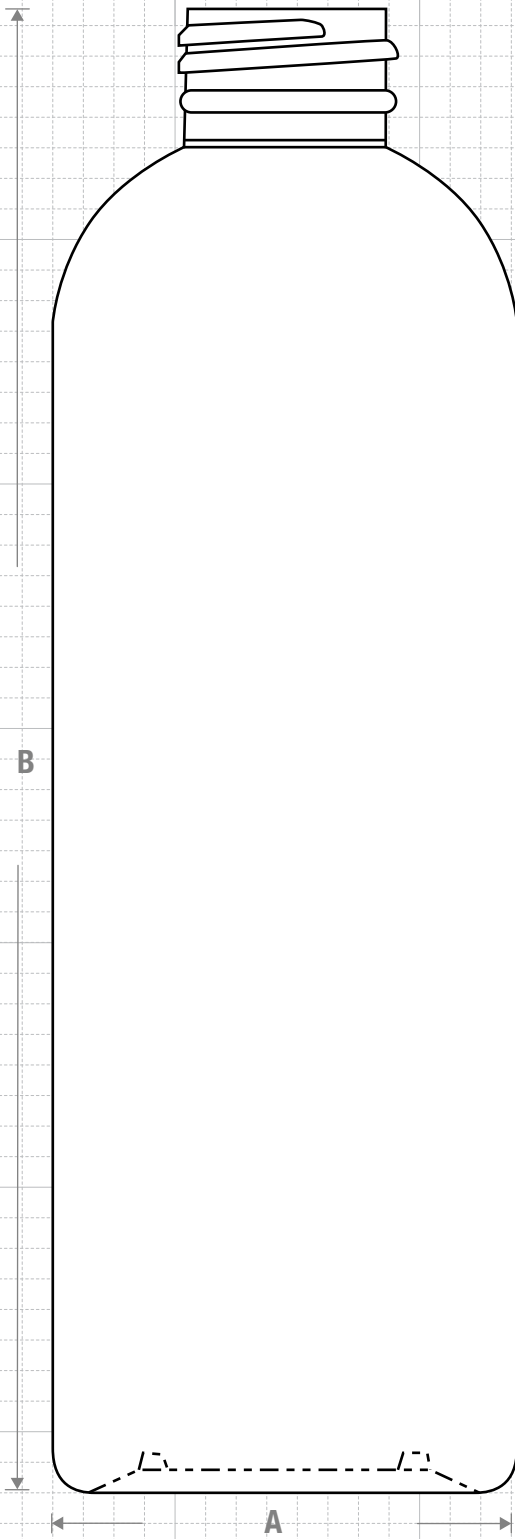

BOTTOM VIEW



CLASSIC CONTAINERS INC
 1700 S. Hellman Ave.
 Ontario, CA 91761
 Phone: 909-930-3610
 e-mail: info@classiccontainers.com
 www.classiccontainers.com

Drawing: 16 oz Royalty Round 28/410	Gram Weight: 32.5 ± 2	Max Print Area (Height): 5.500"	Cases Per Pallet: 16
Stock Code: 001600040280000	Neck Finish: 28/410	Max Print Area (Width): 7.500"	Box Dimensions: 24 7/16 x 18 1/2 x 23
Manufacturing Process: Extrusion Blow Molding	Base Width (A): 2.500± 0.050	Case Pack: 231	Stock Material:
Overflow Capacity: 496 -519 ml (16.8 - 17.6 oz)	Overall Height (B): 7.660 ± 0.050	Case Weight (lb): 19.5 ± 1.0	Rev #4 08/2019 Drawing not exactly to size.

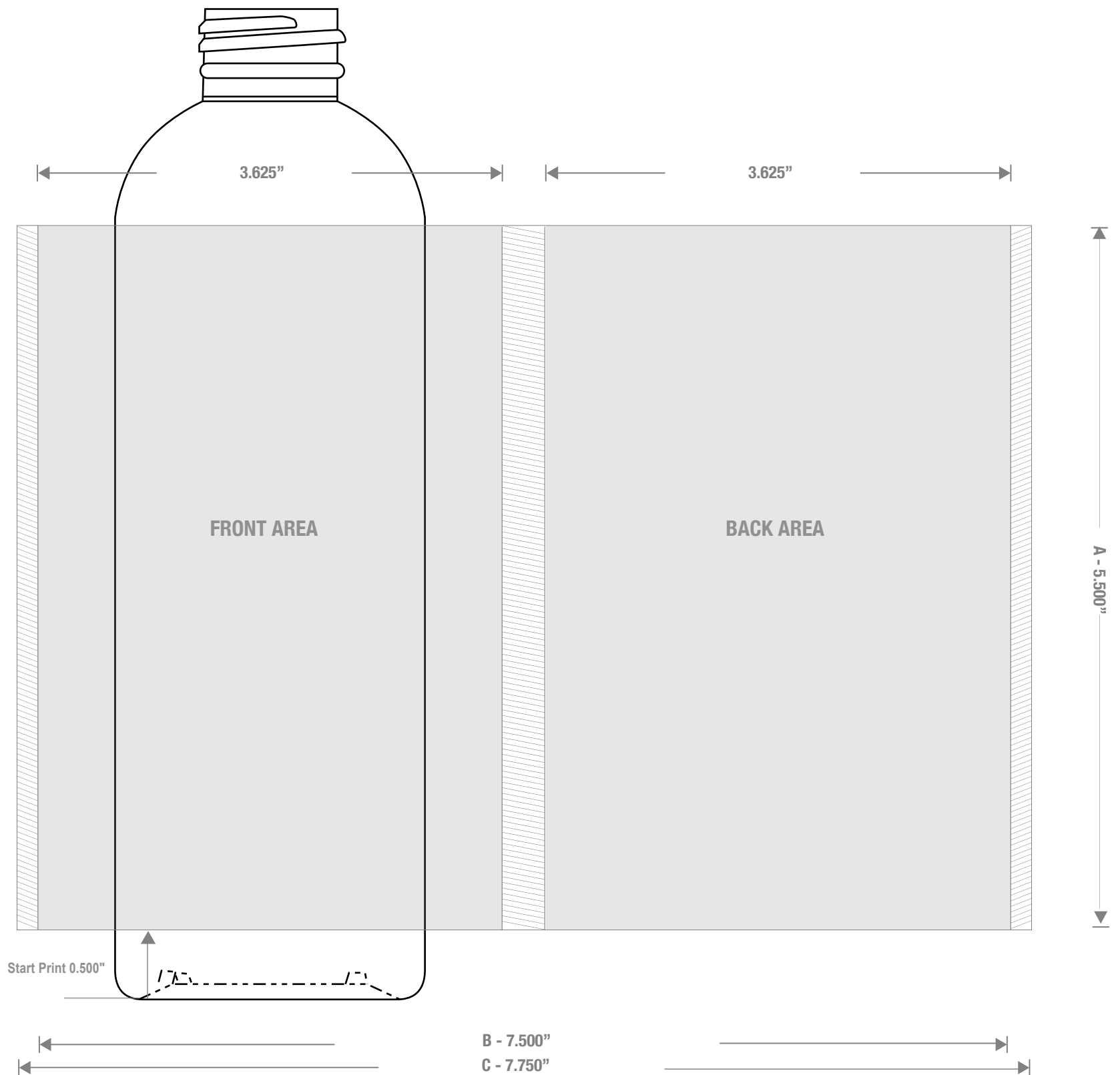

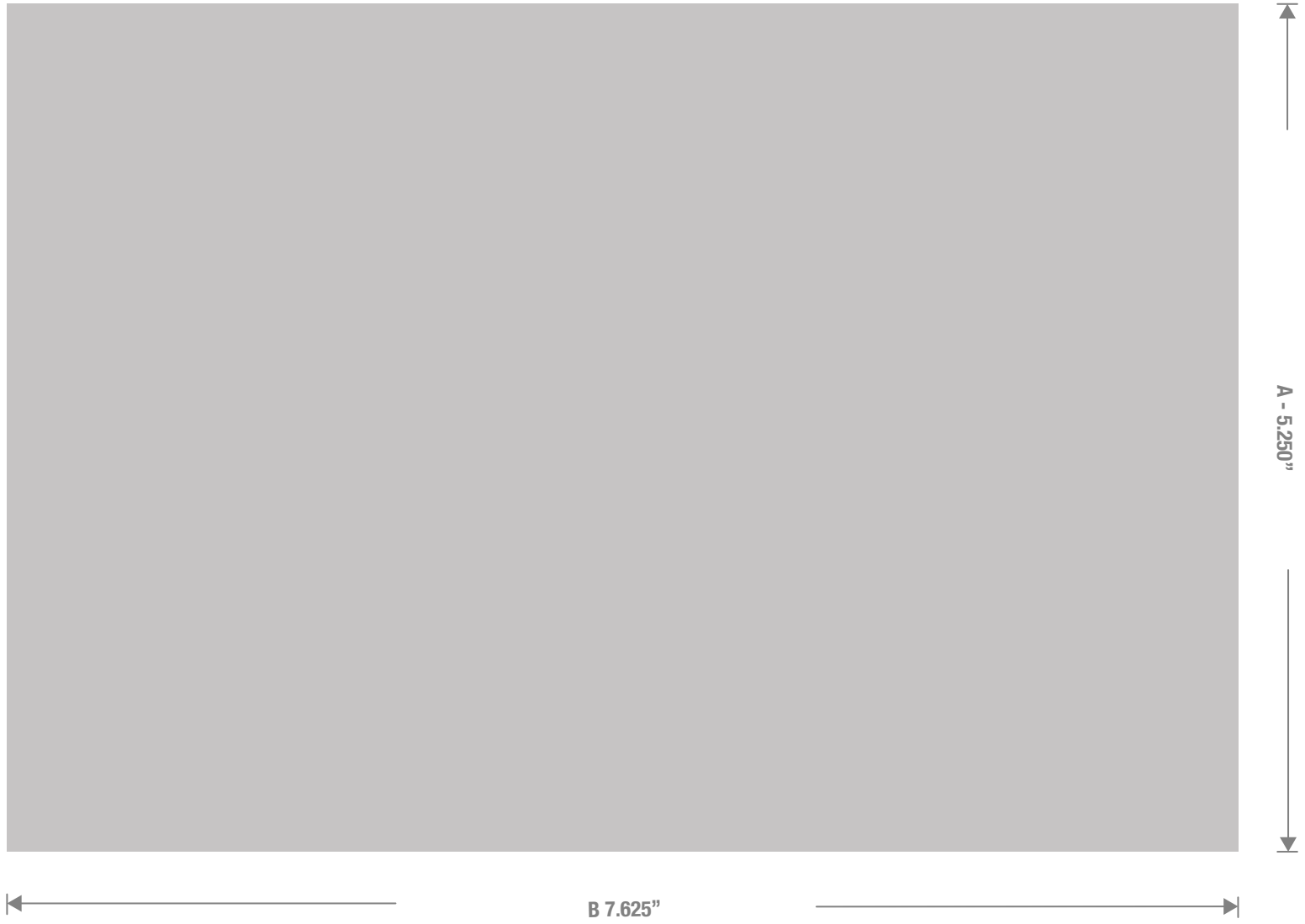

1700 S Hellman Ave, Ontario, California 91761
Phone: (909) 930-3610 | Fax: (909) 930-3640
e-mail: info@classiccontainers.com
www.classiccontainers.com

A - Total Height.
B - Total bottle circumference.